

Soils Map

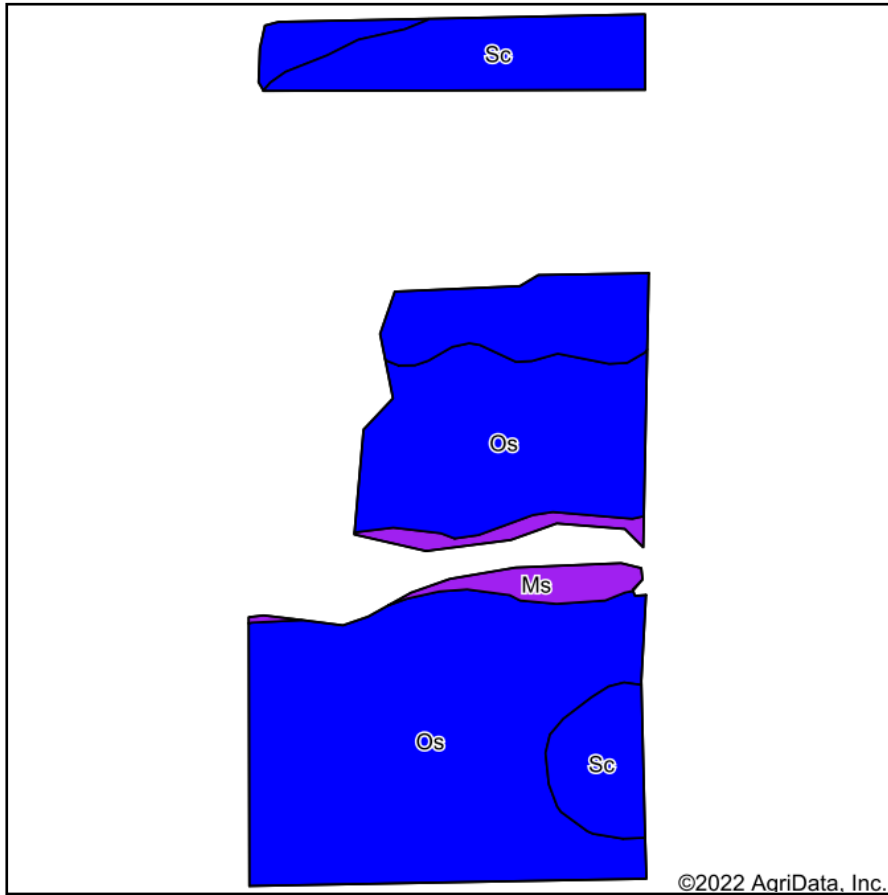

Soils data provided by USDA and NRCS.

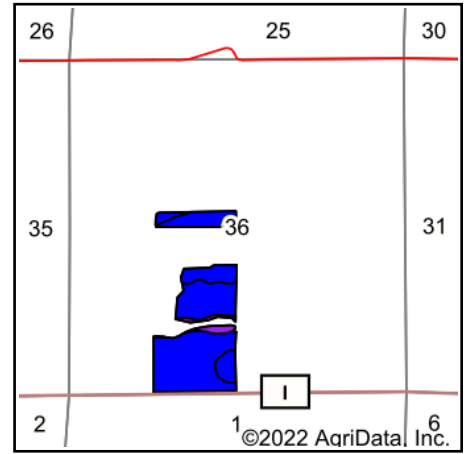

State: **Wisconsin**
 County: **Langlade**
 Location: **36-32N-10E**
 Township: **Peck**
 Acres: **53.52**
 Date: **3/28/2022**



WHITETAIL PROPERTIES REAL ESTATE
 HUNTING | RANCH | FARM | TIMBER

Maps Provided By:



© AgriData, Inc. 2021

www.AgriDataInc.com



Area Symbol: WI067, Soil Area Version: 17

Code	Soil Description	Acres	Percent of field	Non-Irr Class Legend	Non-Irr Class *c	*n NCCPI Overall	*n NCCPI Corn	*n NCCPI Soybeans
Os	Ossmer silt loam, 0 to 3 percent slopes	37.27	69.6%		IIw	56	56	45
Sc	Billyboy silt loam, 0 to 3 percent slopes	13.75	25.7%		IIs	56	56	40
Ms	Minocqua, Cable, and Sherry mucks	2.50	4.7%		VIw	58	58	37
Weighted Average					2.19	*n 56.1	*n 56.1	*n 43.3

*n: The aggregation method is "Weighted Average using all components"

*c: Using Capabilities Class Dominant Condition Aggregation Method

Soils data provided by USDA and NRCS.