

Soils Map

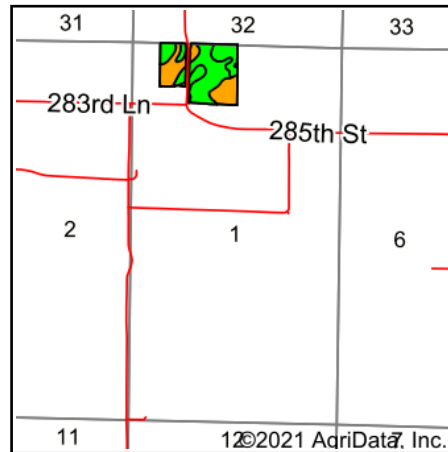

State: **Iowa**
 County: **Guthrie**
 Location: **1-78N-31W**
 Township: **Jackson**
 Acres: **57.11**
 Date: **8/2/2021**

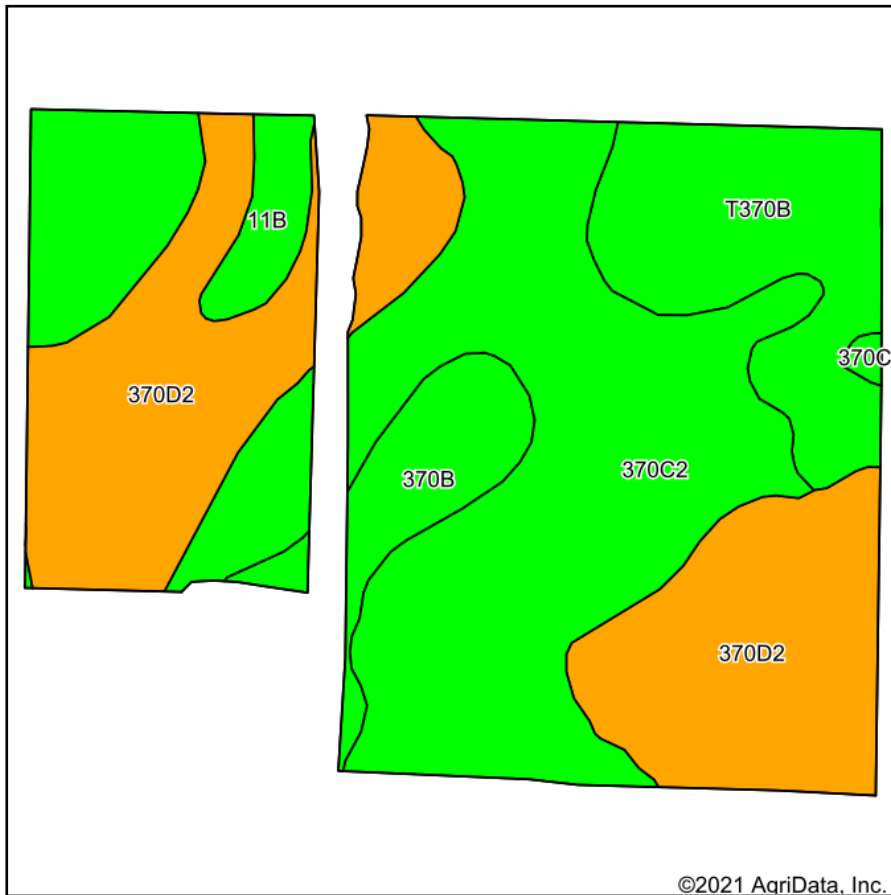

WHITETAIL PROPERTIES REAL ESTATE
 HUNTING | RANCH | FARM | TIMBER

Maps Provided By:



Soils data provided by USDA and NRCS.

Area Symbol: IA077, Soil Area Version: 29

Code	Soil Description	Acres	Percent of field	CSR2 Legend	CSR2**	*n NCCPI Overall	*n NCCPI Corn	*n NCCPI Small Grains	*n NCCPI Soybeans
370C2	Sharpsburg silty clay loam, 5 to 9 percent slopes, eroded	25.26	44.2%		80	84	84	69	67
370D2	Sharpsburg silty clay loam, 9 to 14 percent slopes, eroded	19.05	33.4%		54	80	80	63	62
T370B	Sharpsburg silty clay loam, terrace, 2 to 5 percent slopes	7.70	13.5%		91	91	91	72	78
370B	Sharpsburg silty clay loam, 2 to 5 percent slopes	3.41	6.0%		91	93	93	78	80
11B	Colo-Judson silty clay loams, 0 to 5 percent slopes, occasionally flooded	1.52	2.7%		80	87	85	49	81
370C	Sharpsburg silty clay loam, 5 to 9 percent slopes	0.17	0.3%		81	90	90	76	76
Weighted Average					73.5	*n 84.2	*n 84.2	*n 67.4	*n 68

**IA has updated the CSR values for each county to CSR2.

*n: The aggregation method is "Weighted Average using all components"

Soils data provided by USDA and NRCS.