

JANES SURVEYING INC.
 222 S. MAIN - P.O. BOX 146
 PALMYRA, MO. 63461
 PHONE 844.789.7020 / FAX 573.789.5512
 WWW.JANESURVEYING.COM

JANES SURVEYING, INC.
 MISSOURI STATE CERTIFICATE OF AUTHORITY #000342
 RENEWAL: 12-31-25

A TRACT OF LAND LYING IN SECTIONS 6 & 7, TOWNSHIP 59 NORTH, RANGE 12 WEST, SHELBY COUNTY & SECTIONS 1 & 12, TOWNSHIP 59 NORTH, RANGE 13 WEST, MACON COUNTY, MISSOURI.

BOUNDARY SURVEY

(AS MADE FOR MIKE AYERS)

NOTE: ALL IMPROVEMENTS ARE TO BE CONSIDERED APPROXIMATE UNLESS DIMENSIONED TO PROPERTY LINES.

THIS PLAT AS A RESULT OF A SURVEY MADE UNDER MY DIRECT SUPERVISION ON MARCH 29, 2024 REPRESENTS A TRUE AND ACCURATE RECORD OF SAID SURVEY AND WAS EXECUTED IN ACCORDANCE WITH THE CURRENT STANDARDS FOR RURAL PROPERTY BOUNDARY SURVEYS OF THE MISSOURI DEPARTMENT OF AGRICULTURE.

3-29-24
 JASON D. JANES, P.L.S. #2004017826 - MISSOURI

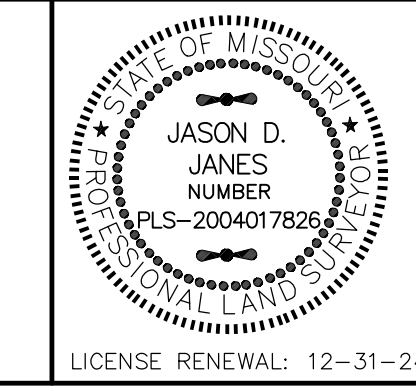

JASON D. JANES, SURVEYOR
 JOB PLS-2004017826

JSI PROJECT NO. 2024-008573

FIELD BOOK NO: 110

FIELD: CREGHTON
 DRAWN: TYLER
 CHECKED: DOUG
 REVISED:
 REVISED:

LICENSE RENEWAL: 12-31-24