

# Soils Map

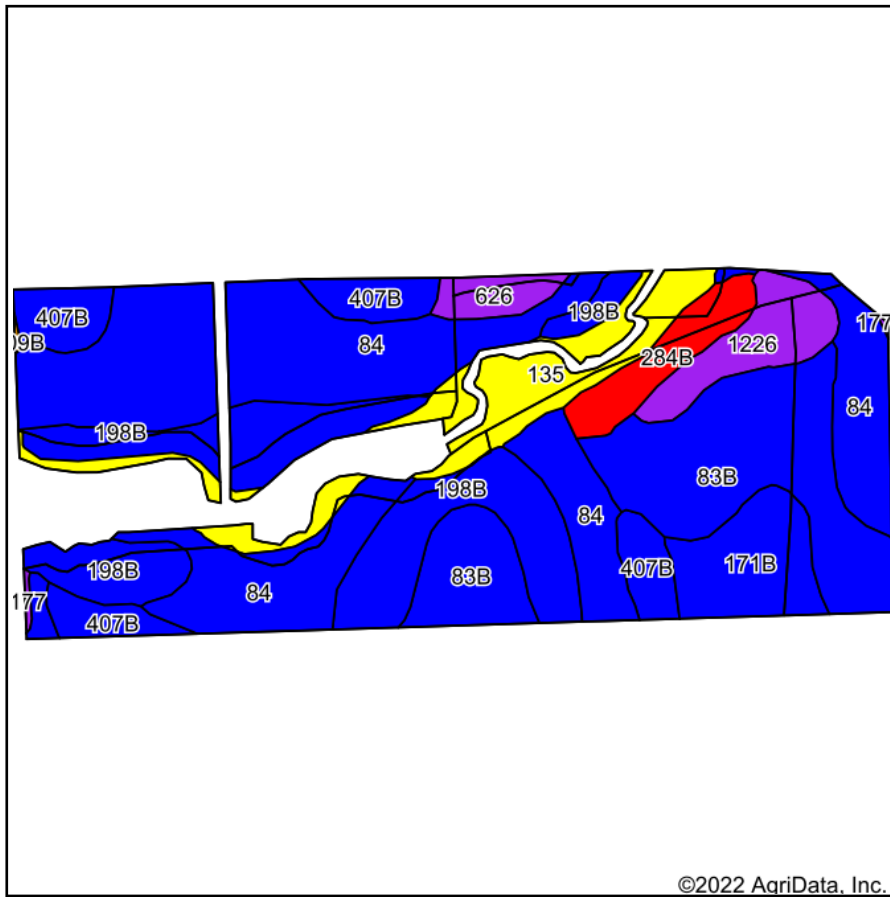

Soils data provided by USDA and NRCS.

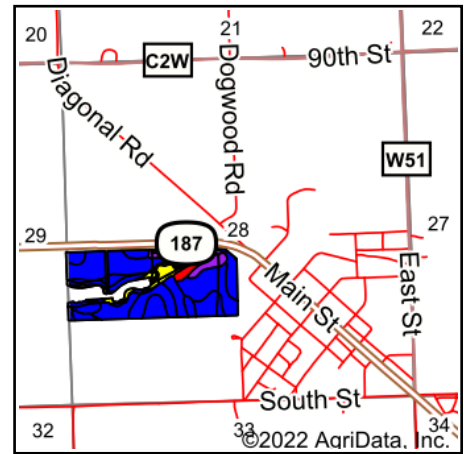

State: **Iowa**  
 County: **Fayette**  
 Location: **28-92N-7W**  
 Township: **Fairfield**  
 Acres: **55.97**  
 Date: **5/23/2022**



WHITETAIL PROPERTIES REAL ESTATE  
 HUNTING | RANCH | FARM | TIMBER

Maps Provided By:



Area Symbol: IA065, Soil Area Version: 26

Code	Soil Description	Acres	Percent of field	CSR2 Legend	CSR2**	*n NCCPI Overall	*n NCCPI Corn	*n NCCPI Soybeans
84	Clyde clay loam, 0 to 3 percent slopes	18.98	33.9%		88	90	90	85
83B	Kenyon loam, 2 to 5 percent slopes	10.23	18.3%		90	87	87	72
198B	Floyd loam, 1 to 4 percent slopes	9.66	17.3%		89	85	81	85
135	Coland clay loam, 0 to 2 percent slopes, occasionally flooded	4.69	8.4%		65	87	87	66
407B	Schley loam, 1 to 4 percent slopes	4.02	7.2%		81	86	86	78
171B	Bassett loam, 2 to 5 percent slopes	3.04	5.4%		85	88	88	76
1226	Lawler loam, 0 to 2 percent slopes, rarely flooded	2.36	4.2%		59	83	83	61
284B	Flagler sandy loam, 2 to 5 percent slopes	1.96	3.5%		49	67	67	37
626	Hayfield loam, 0 to 2 percent slopes, rarely flooded	0.96	1.7%		53	85	85	58
177	Saude loam, 0 to 2 percent slopes	0.07	0.1%		60	78	78	61
Weighted Average					82.7	*n 86.7	*n 86	*n 76.9

\*\*IA has updated the CSR values for each county to CSR2.

\*n: The aggregation method is "Weighted Average using all components"

Soils data provided by USDA and NRCS.